



## Press release



Louise Hervé & Chloé Maillet  
*Attraction étrange / Strange Attraction*

25.02.2012 - 13.05.2012

Opening Friday 24 February 6:30 pm

**Since 2001, Louise Hervé and Chloé Maillet have been developing a unique approach, through the production of films, novels, radio programs and “didactic performances”.** The latter take the form of speeches during which they literally draw the audience into the twists and turns of the narrative, where science and fiction happily meet.

The two young women are more particularly interested in historical characters relegated to the shadows, events that have been passed over in silence, works that are despised or have faded into oblivion. In terms of cinema they are more likely to unearth an outdated epic from the 1950s than one of the indisputable classics.

Their work could be seen as a restoration project. Like archaeologists, they reconstruct worlds by means of scattered fragments and entangled temporal strata in which Stendhal, chaos theory, and the dinosaurs of *Jurassic Park* easily coexist.

If caves, underpasses and tunnels are recurring settings in their story, this is surely because one must go underground before understanding what is happening on the surface.

Archives, museums, libraries, excavation sites and storerooms are at one and the same time their workshops and their formal models, where they find the spirit of their future work...

**For the Synagogue de Delme, Louise Hervé et Chloé Maillet have conceived a space that is a cross between a reading room and a museum reserve collection.**

In the reading room located on the ground floor of the art centre, over the weeks visitors will discover a serialized novel written in the great tradition of the 19th century press. The novel will be published every Thursday in the local edition of the newspaper *Républicain Lorrain*, and will bring together historical figures such as Pythagoras, Louis Pasteur, Gilgamesh and Christine de Pizan. Visitors will be able to see the beginning of the novel at the exhibition opening, and then its ten episodes will be exhibited week after week in the reading room that has been created for the occasion.

The upper floor houses a reserve collection specially assembled for the exhibition, consisting of artifacts borrowed from the Delme archeological collection, from the Musée du Sel in Marsal, and from the Musée Barrois in Bar-le-Duc. Crystals, busts of historical figures, Merovingian buckle plates, fragments of Roman amphoras... represent the imaginative world of the text displayed on the ground floor. The central motif of the novel is “crystallization”—a metaphor for the process of love, as elaborated by Stendhal in his book *On Love*, but also in the sense of the crystallization of ideas...

## Practical details

25.02.2012 - 13.05.2012

Opening Friday 24 February at 6:30 pm

Wednesday-Saturday : 2-6pm

Sundays : 11am-6pm

Admission free

### Publication of the serialized novel

Louise Hervé and Chloé Maillet are composing a serialized novel, to appear in the local pages of the newspaper *Républicain Lorrain*: every Thursday from 23 February to 10 May.

## Related events

### Reading by an actor

A reading of the serialized novel by an actor, followed by a guided tour:  
Sunday 22 April at 4pm.

### Guided tour

Guided tour with Laurène Macé, Visitor Service Officer : every Sunday at 4:00 pm.  
Admission free.

### Publication

In conjunction with Galerie Marcelle Alix, the art centre is producing an artist's book, to be published in late 2012.

## Press

Agathe Borgne, Media Relations Officer  
communication@cac-synagoguedelme.org  
+33(0)3 87 01 43 42

Press kit downloadable on:  
[www.cac-synagoguedelme.org/presse](http://www.cac-synagoguedelme.org/presse)  
Visuals available on request



## Location

Centre d'art contemporain la synagogue de Delme  
33 rue Poincaré 57590 Delme  
T 03 87 01 43 42 F 03 87 01 43 14  
[www.cac-synagoguedelme.org](http://www.cac-synagoguedelme.org)  
[cac.delme@wanadoo.fr](mailto:cac.delme@wanadoo.fr)

## Acces

From Paris (by train, 90 mins):  
TGV Est, towards Metz or Nancy

From Metz (by car, 30 mins):  
D955 (formerly route de Strasbourg)

From Nancy (by car, 40 mins):  
N74 towards Château-Salins  
then D955 towards Metz

## Exhibition partners

This exhibition is the product of a special partnership between the art centre and the Barrois Museum in Bar-le-duc, the Musée départemental du Sel in Marsal, the Delme archaeological association *Ad Duodecimum*, the CIAV (Centre International d'Art Verrier) in Meisenthal and the newspaper *Le Républicain Lorrain*.

## Artists with a presence in Lorraine since 2008

In 2008 Louise Hervé and Chloé Maillet were granted a three-month residency as part of the Lindre-Basse residency program. During that time they shot their second film, entitled *Un projet important* (*An Important Project*).

Since then, the art centre has regularly supported their work through various invitations: in 2009, in the context of the festival *Toutes les voix comptent* (*All Voices Count*), in partnership with the Metz Art School and the FRAC Lorraine, and then in the context of the *White Night* in Metz. In Delme in 2011, they presented a performance entitled *L'ultime suggestion du Docteur Coué* (*Dr. Coué's Final Suggestion*), which took the form of a collective hypnosis session, and echoed the exhibition *The Thousand Dreams of Stellavista*.

## Biography

Born in 1981, Louise Hervé et Chloé Maillet live in Paris.  
Represented by Marcelle Alix Gallery, Paris.

## Solo Exhibitions

- 2012 Kunsthaus Glarus, Switzerland  
Kunstverein Braunschweig, Deutschland
- 2011 *Où l'on incendie le diorama*, Frac Champagne Ardenne, Reims, France
- 2010 *The Dragon's cave or the Burying*, Galerie Marcelle Alix, Paris, France

## Selected Group Exhibitions

- 2012 La Triennale de Paris, Palais de Tokyo, Paris, France
- 2011 *Les marques aveugles*, Centre d'art contemporain de Genève, Switzerland  
*Revisiting time*, FRAC Nord Pas-de-Calais, Dunkerque, France  
*Eldorado*, Bétonsalon, Paris, France
- 2010 *Derrière les panneaux il y a des hommes*, La Tôlerie, Clermont-Ferrand, France  
*Dynasty*, Palais de Tokyo / Musée d'art moderne de la ville de Paris  
*A walk around the block*, La ferme du Buisson, Marne-la-Vallée, France  
*We do not live on the outside of the globe (past and future reconstruction)*, Croy-Nielsen Gallery, Berlin, Deutschland
- 2009 *Le plan méthodique de F. Le Play*, Palais de Tokyo, Paris, France  
*The third place/ Der dritte Ort*, Grazer Kunstverein, Graz, Austria  
*Ange Leccia et le Pavillon*, Nuit des musées, Musée Bourdelle, Paris, France

## Performances

- 2011 Théâtre National de Chaillot, Paris, France  
Fondation d'entreprise Ricard, Paris, France
- 2010 Biennale de Belleville, Paris, France  
Benaki Museum, Athens, Greece  
Raven Row, London, United-Kingdom  
Le plateau-Frac Ile-de-France, Paris, France  
*Hors-pistes Festival*, Centre Georges Pompidou, Paris, France
- 2009 *Zéro Budget Biennial*, Galerie Carlos Cardenas, Paris, France  
*le forum de l'image Festival*, Les abattoirs, Toulouse, France  
*Toutes les voix comptent Festival*, CAC La synagogue de Delme, France  
MAC/VAL, Vitry, France  
Atelier de création radiophonique, France Culture
- 2008 La Box/ENSAB, Bourges, France  
Lindre-Basse Résidency, CAC la synagogue de Delme, France



## Coming up in 2012

### Erick Beltrán: Solo exhibition, June - September 2012

Born in 1974, Mexican artist Erick Beltrán is fascinated by how information is constantly distributed, organized, filtered, reconstructed... Whether it is a matter of images or words, at the heart of his reflection is language and the way it determines our relationship to the world.

Erick Beltrán uses printed material, newspapers, leaflets, publications, as so many media for broadcasting his work. By covering the exhibition spaces with diagrams, plans, and various graphical systems, he offers a mental cartography as well as a representation of the world, with truly labyrinthine visual effects.

### Public commission in progress:

#### *Gue(ho)st House*, a work by Berdaguer & Péjus in Delme

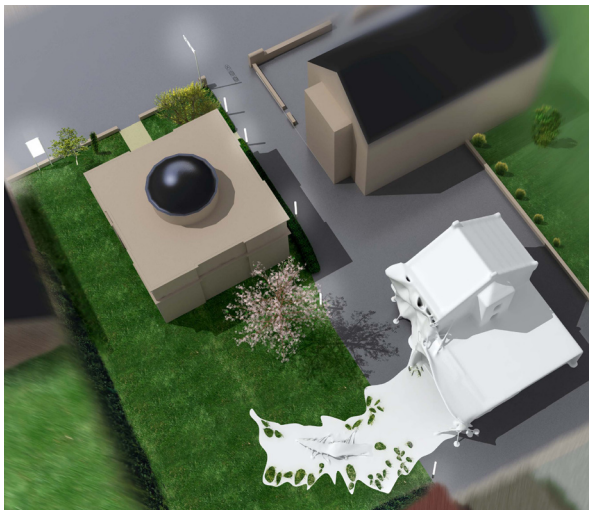

© G.Robillard

veritable architectural phantasmagoria, or “the art of making ghosts speak in public”. So they intend to cover the existing house in a white resin topping that flows onto the surrounding area, creating organic shapes on one of the facades, which truly becomes a living, moving body.

#### **A two-phase project**

After the first phase—the interior restoration of the house—from September 2011 to January 2012, the second phase will begin at the end of March, with the implementation of all of the exterior elements: a polystyrene sculpture covered with sprayed resin, paint, an illuminated path, signage, the revegetation of the space behind the synagogue.

#### **Future uses**

The ground floor of this new building will contain a reception centre for groups and schoolchildren, as well as for the art centre’s educational events, but also a reception office and a documentation centre. The upper floor will be transformed into a two-room studio to occasionally accommodate artists during their set-up times.

*Planned opening: summer 2012*

*Group visits to the worksite available upon reservation until May 2012.*

*After the opening, visiting hours will be those of the art centre, admission free.*

#### **The Delme art centre is growing...**

The area surrounding the contemporary art centre is currently under renovation, in the context of the public commission initiated by the Minister of Culture in 2006.

The goal of the commission awarded to artists Berdaguer and Péjus is to create new signage and lighting for the synagogue, but also to create new spaces for welcoming visitors and artists. Thus the building located at the back of the art centre, which was successively a prison, a shop, a school and then a funeral home, is being restored and completely transformed.

#### **An architecture-sculpture to experience, in connection with the building’s memory.**

The artists wished to work with the building’s memory and its series of past uses: they are literally transforming it into a ghost house, a



d.c.a

La synagogue de Delme Centre for Contemporary Art is a member of DCA-Association pour le Développement des Centres d'Art.

La synagogue de Delme Centre for Contemporary Art is grateful for support from the French Ministry of Culture and Communication, the Lorraine contemporary art authority (DRAC), the regional and departmental governments of Lorraine and Moselle, and the municipality of Delme.



*Erick Beltrán’s exhibition is presented the context of MONO, 18 monographs by modern and contemporary artists from Grande Région/ Groß Region, from 1 June to 2 September 2012.*



CENTRE D'ART CONTEMPORAIN LA SYNAGOGUE DE DELME / *ATTRACION ÉTRANGE* Louise HERVÉ & Chloé MAILLET/ 25.02.2012-13.05.2012  
33 rue Poincaré F - 57590 Delme / +33 (0)3 87 01 43 42 / [www.cac-synagoguedelme.org](http://www.cac-synagoguedelme.org) / [cac.delme@wanadoo.fr](mailto:cac.delme@wanadoo.fr)